



Fluid
extractor

K 10655



This fluid extractor is ideal when extracting fluids such as oil , brake fluid, water, etc. It's designed to be pneumatic or manually operated. Before use, carefully read through these instructions.

SAFETY AND PRECAUTION

Read these instructions before starting the refilling process

- 1 Always follow instructions provided by the vehicle manufacturer regarding handling and safety measures.
- 2 Wear gloves and eye protection when working with fluids that can be harmful when in contact with eyes or skin.
- 3 Keep out of reach for children.
- 4 Never extract or store dangerous chemicals, poisons, acids, alkaline or solvents. If by chance, such fluids has entered the unit, it must immediately be drained and cleaned.
- 5 Flammable fluids such as petrol, diesel or kerosene may be extracted with this unit, but never use the unit to store them.
- 6 Do not dismantle, tamper with or adapt the unit for other purpose than what it's originally intended for.
- 7 Do not store the unit in areas with high temperatures or in direct sunlight.
- 8 The vapor can be flammable or poisonous so caution should be used when extracting fluids.
- 9 The temperature of fluid should be between 1 and 95°C
- 10 The air pressure range is between 2,8 and 3–12 bar
never use air pressure outside these limits.

PRODUCT SPECIFICATIONS

Volume: 6 liter

Average air consumption: 57 l/m

Working pressure: 3–12 bar (0,3 – 1,2MPa)

Fluid temperature range: 1-95°C

Includes following hoses:

- 1m, Ø9,8 mm nylon fluid hose with extractor connector
- 1m, Ø6,7mm nylon fluid hose extension
- 1m, Ø4,5mm nylon fluid hose extension
- 1,5m, Ø8,0mm silicone brake/clutch suction hose with extractor connector

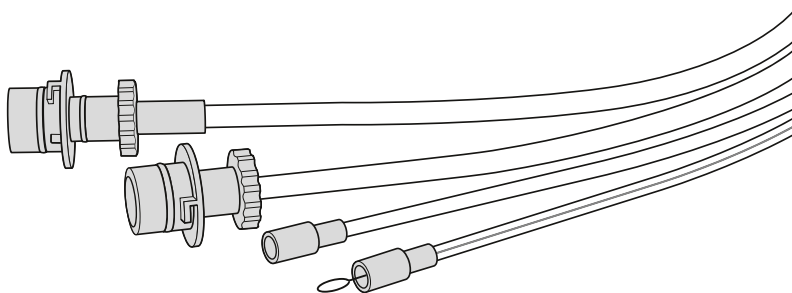

OPERATION INSTRUCTIONS

- 1 If the fluid is to be refilled, check that no residue from other fluids are left in the extractor. These could have a negative impact on the end result.
- 2 For best performance, use a hose with as big diameter as possible.
- 3 Before connecting the air hose, or starting to operate the extractor manually, make sure the air valve is closed (pict.1)
- 4 Mount the suction hose by inserting the adapter in the mounting hole and turning it counter clockwise (pict.2)
- 5 If needed, attach the 6,7 mm or 4,5 mm extensions.
Note that the 4,5 mm extension hose has a lead wire to facilitate the introduction of the hose.
- 6 Insert the suction hose as close to the bottom of the oil reservoir/tank as possible without blocking its opening.
- 7 A) Pneumatic operated: open the air valve (pict 3a).
B) Manually operated: start pumping without opening the valve (pict 3b).

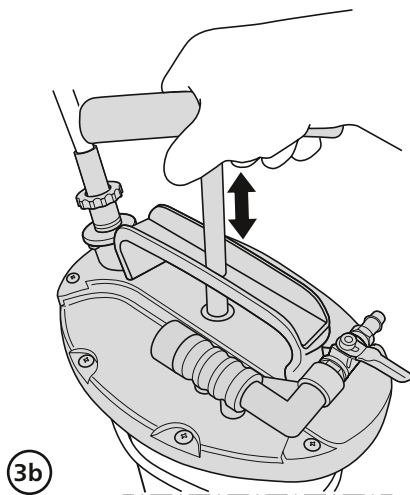
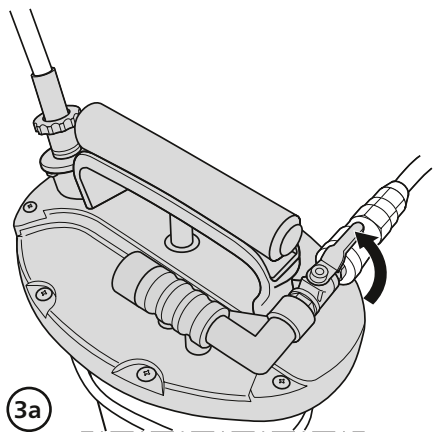
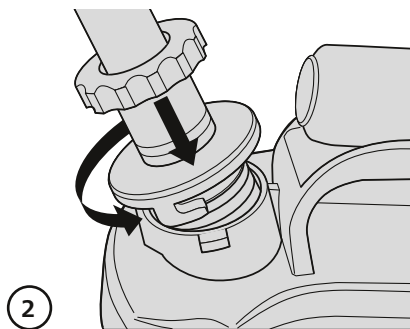
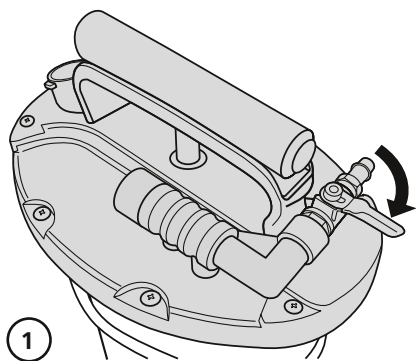

OPERATION INSTRUCTIONS

- 8 Shut the air valve when all fluid is collected and detach the air hose (pict 4).
- 9 To empty the extractor, detach the suction hose by turning the adapter clockwise and pulling out. (pict 5)
- 10 To pour out the fluid from the extractor without accidentally filling the safety valve with fluid, it must be held in a correct way (pict. 6). Also note the fluid drain limit line on the extractor.
- 11 The brake/ clutch suction hose is operated in a similar way as described above but is also equipped with a shut off valve to facilitate brake bleeding (pict 7).

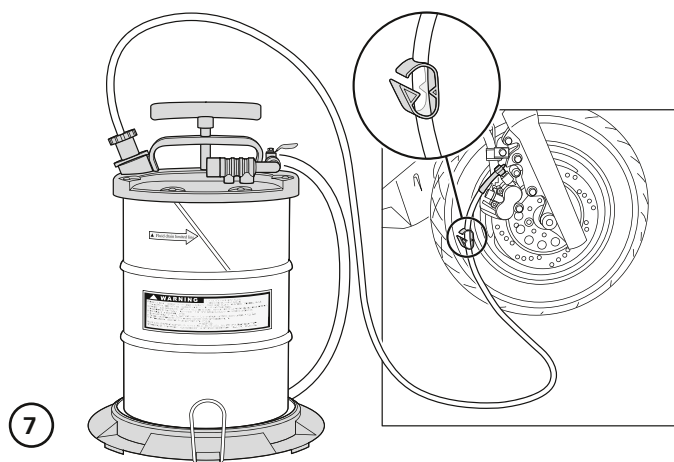
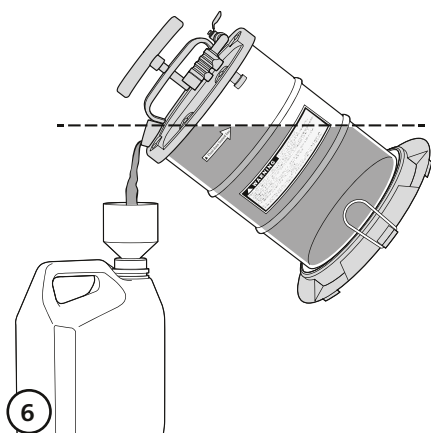
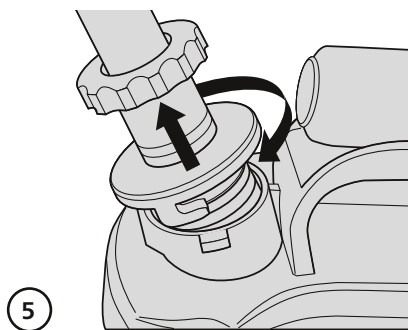
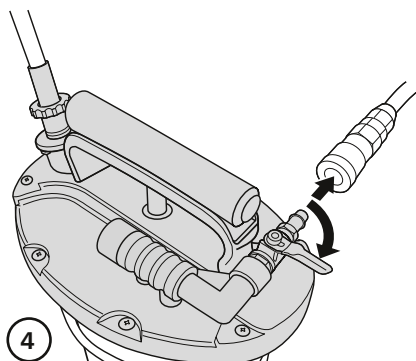

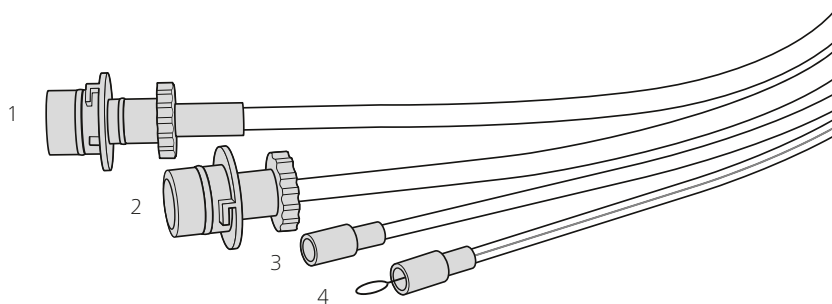

PART LIST

Pos.	Parts No.	Description
1	K 10656	1,5m, brake/ clutch suction hose with connector to extractor
2	K 10657	1m, Ø9,8 mm fluid hose with extractor connector
3	K 10658	1m, Ø6,7mm fluid hose extension
4	K 10659	1m, Ø4,5mm fluid hose extension with lead wire

K 10655

www.kamasatools.com